

HOUSE

- 40 x 40 D. [8' CEILING]

-ENTRY DORMER

TYPE 3 - 24'

SALT CAVE

- 24(B) x 24 D.

- ENTRY DORMER

TYPE 2 - 12'

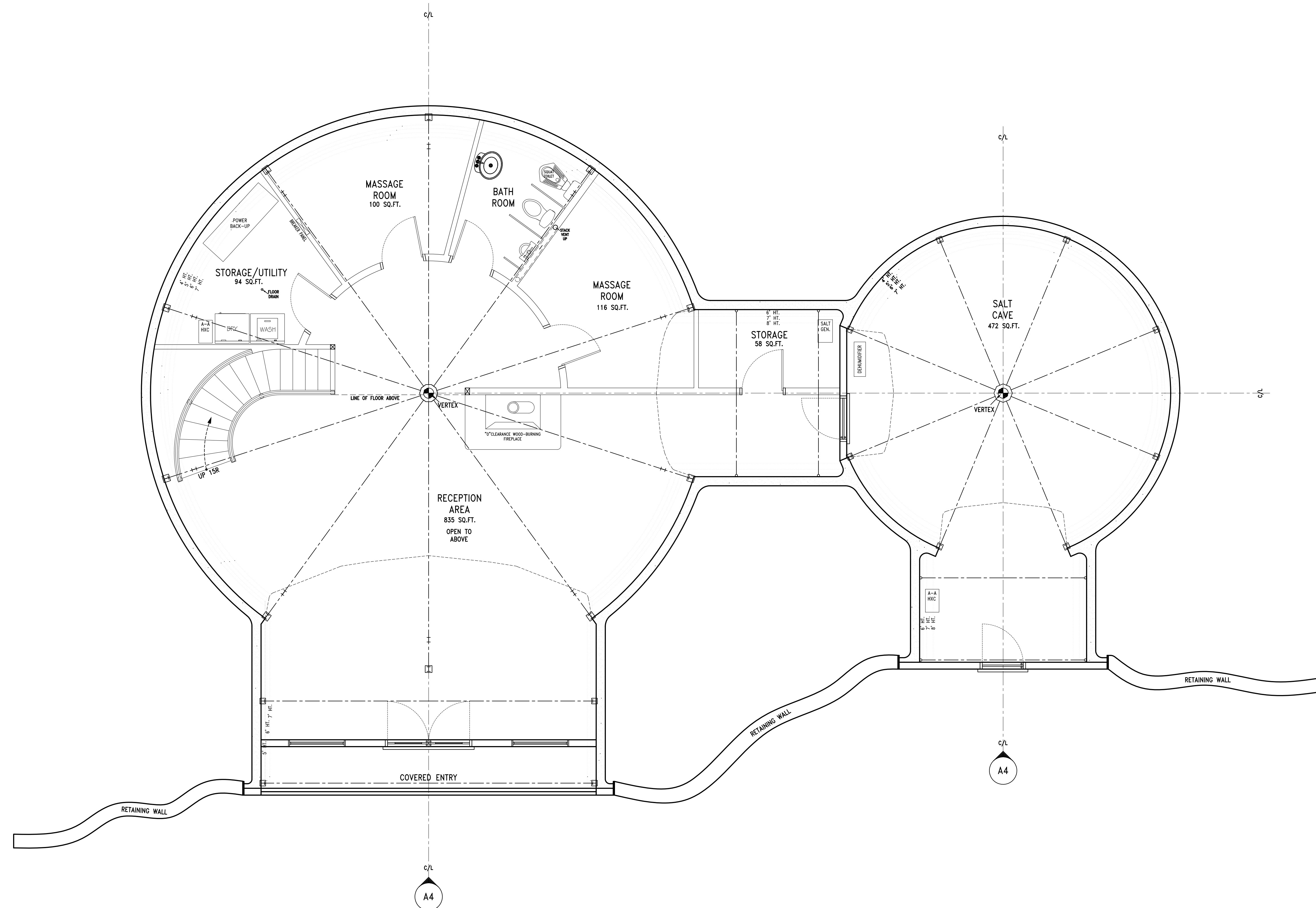

PLANS AND DESIGNS ARE THE PROPERTY OF FORMWORKS BUILDING, INC. ANY REPRODUCTION OR DISTRIBUTION OF THESE PLANS WITHOUT THE WRITTEN PERMISSION OF FORMWORKS BUILDING, INC. IS STRICTLY PROHIBITED. THE CONTRACTOR SHALL BE RESPONSIBLE FOR OBTAINING ALL NECESSARY PERMITS AND APPROVALS FROM THE LOCAL, STATE, AND FEDERAL AUTHORITIES. THE CONTRACTOR SHALL BE RESPONSIBLE FOR THE COST OF OBTAINING PERMITS AND APPROVALS.

LOWER LEVEL FLOOR PLAN
 1/4" = 1'-0"
 0 1 2 4

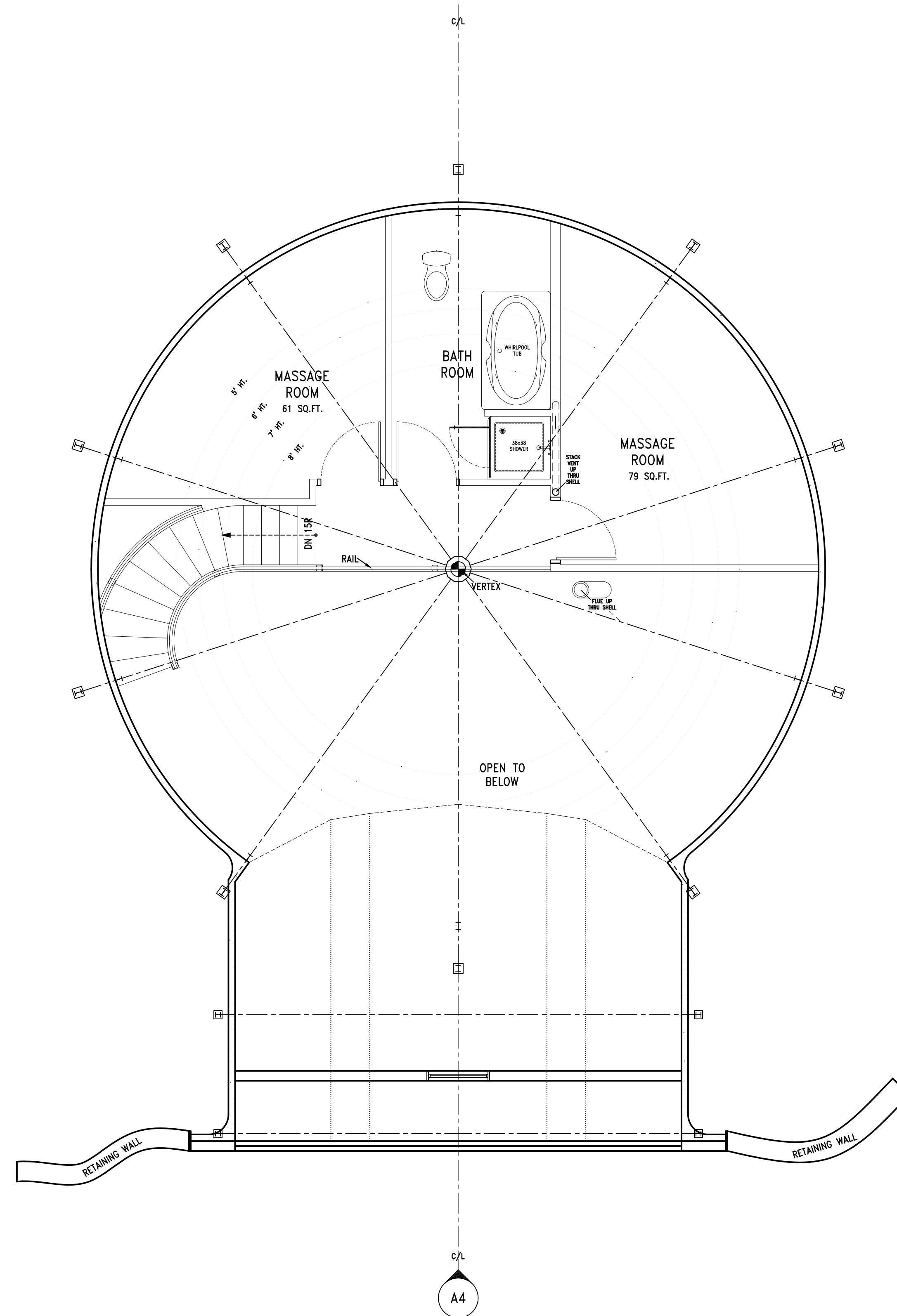

UPPER LEVEL FLOOR PLAN

1/4" = 1'-0"
 0 1 2 4

PLANS AND DESIGNS ARE THE PROPERTY OF FORMWORKS BUILDING, INC. ANY REPRODUCTION OR USE OF THESE PLANS WITHOUT THE WRITTEN PERMISSION OF FORMWORKS BUILDING, INC. IS STRICTLY PROHIBITED. THE CONTRACTOR AND SUBCONTRACTOR SHALL BE RESPONSIBLE FOR VERIFYING ALL CONDITIONS PRIOR TO THE START OF CONSTRUCTION OR FABRICATION.

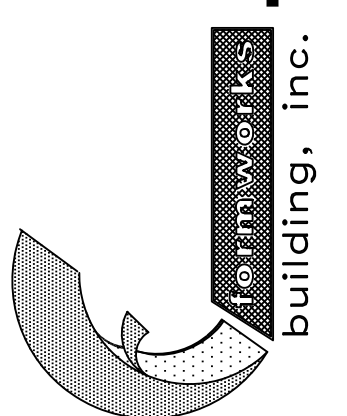

formworks building, inc.
 p.o. box 1509 durango, co 81302